

Always at the right moment.

ATE brake discs with bearings: prescribed tightening torques.



Manufacturer	Model	ATE article no.	Range ID	Range name	from	to	QualColText	Tightening torques wheel bearings (Nm)	
ALFA ROMEO	75 (86-92)	24.0122-0119.2	306	75 (162B_)	01.05.1985	01.12.1992	Standard	265-324	
	90 (84-87)	24.0122-0119.2	310	90 (162_)	01.10.1984	01.07.1987	-	266-324	
	Giulietta (77-85)	24.0122-0119.2	477	GIULIETTA (116_)	01.10.1977	01.12.1985	-	267-324	
	GTV (81-87)	24.0122-0119.2	1403	GTV (116_)	01.01.1978	01.02.1987	-	268-324	
CITROËN	Berlingo (B9) (08-)	24.0112-0194.2	7683	BERLINGO (B9)	01.04.2008	-	Center nut	300	
	BX (82-93)	24.0107-0105.2	404	BX (XB_)	01.10.1982	01.06.1994	-	270	
	C4 I Grand Picasso (06-13)	24.0112-0194.2	5424	C4 Grand Picasso I (UA_)	01.10.2006	-	Center nut	300	
	C4 I Picasso (07-13)	24.0112-0194.2	4830	C4 Picasso I (JD_)	01.10.2006	01.08.2013	Center nut	300	
	C4 II Sedan (B7) (10-)	24.0112-0194.2	8836	C4 II (NC_)	01.11.2009	-	Center nut	300	
	C4 II Sedan (B7) (10-)	24.0109-0171.2	8836	C4 II (NC_)	01.11.2009	-	Center nut	300	
	D54 (11-)	24.0112-0194.2	8997	D54 (NX_)	01.04.2011	01.07.2015	Center nut	300	
	D54 (11-)	24.0109-0171.2	8997	D54 (NX_)	01.04.2011	01.07.2015	Center nut	300	
	D55 (11-)	24.0112-0194.2	9298	D55 (KD_ KF_)	01.11.2011	01.07.2015	Center nut	300	
	D55 (11-)	24.0112-0198.1	9298	D55 (KD_ KF_)	01.11.2011	01.07.2015	Hybrid, 4x4	345	
	XM (Y3) (89-94)	24.0109-0121.2	119	XM (Y3)	01.05.1989	01.10.1994	-	275	
	XM (Y3) Estate (91-94)	24.0112-0136.2	124	XM Break (Y3)	01.05.1989	01.07.1994	-	275	
	XM (Y3) Sedan (89-94)	24.0112-0136.2	119	XM (Y3)	01.05.1989	01.10.1994	-	275	
	XM (Y4) (94-00)	24.0109-0121.2	1430	XM (Y4)	01.05.1994	01.10.2000	-	275	
	XM (Y4) (94-00)	24.0112-0136.2	1430	XM (Y4)	01.05.1994	01.10.2000	-	275	
	MERCEDES-BENZ	Citan (W415) (12-)	24.0111-0182.2	9935	CITAN Estate (415)	01.11.2012	-	Center nut	300
OPEL	Vivaro B (14-)	24.0112-0217.2	12093	VIVARO Van	01.06.2014	-	Center nut	280	
PEUGEOT	3008 (09-)	24.0112-0194.2	8541	3008 (OU_ HU_)	01.06.2009	-	Center nut	300	
	3008 (09-)	24.0112-0194.2	8541	3008 (OU_ HU_)	01.06.2009	-	Hybrid	354	
	308 CC (09-15)	24.0109-0171.2	8308	308 CC (4B_)	01.04.2009	-	GTI	300 +/-30	
	308 CC (09-15)	24.0109-0171.2	8308	308 CC (4B_)	01.04.2009	-	Center nut	300 +/-30	
	308 Sedan (07-13)	24.0109-0171.2	7553	308 (4A_ 4C_)	01.09.2007	-	GTI	300 +/-30	
	308 Sedan (07-13)	24.0109-0171.2	7553	308 (4A_ 4C_)	01.09.2007	-	Center nut	300	
	308 SW (08-14)	24.0112-0194.2	7669	308 SW (4H_)	01.09.2007	-	Center nut	300	
	308 SW (08-14)	24.0109-0171.2	7669	308 SW (4H_)	01.09.2007	-	Center nut	300	
	5008 (09-)	24.0112-0194.2	8663	5008 (0A_ 0E_)	01.06.2009	-	Center nut	300	
	Partner Tepee/Van/Flatbed (B9) (08-)	24.0112-0194.2	7697	PARTNER Van (Z_)	01.04.2008	-	Center nut	300	
	Partner Tepee/Van/Flatbed (B9) (08-)	24.0112-0194.2	7698	PARTNER Tepee (Z_)	01.04.2008	-	Center nut	300	
	Partner Tepee/Van/Flatbed (B9) (08-)	24.0112-0194.2	8621	PARTNER Flatbed/Chassis (Z_)	01.01.2009	-	Center nut	300	
	RENAULT	Clio II Sedan (BB_/CB_) (98-12)	24.0108-0117.2	1510	CLIO II (B80/1/2_ CB0/1/2_)	01.09.1998	-	Center nut	175
		Clio III (BR_/CR_) (05-12)	24.0111-0183.2	4232	CLIO III (BR0/1_ CR0/1)	01.01.2005	-	Center nut	175
		Clio IV (B9B_) (12-) Scénic III	24.0108-0118.2	9927	CLIO IV (BH_)	01.11.2012	-	Center nut	280
		Fluence (L30_) (10-)	24.0108-0116.2	8698	FLUENCE (L30_)	01.02.2010	-	Center nut level 01	80
		Fluence (L30_) (10-)	24.0108-0116.2	8698	FLUENCE (L30_)	01.02.2010	-	Center nut level 02	220
		Fluence (L30_) (10-)	24.0111-0180.2	8698	FLUENCE (L30_)	01.02.2010	-	Center nut level 01	80
		Fluence (L30_) (10-)	24.0111-0180.2	8698	FLUENCE (L30_)	01.02.2010	-	Center nut level 02	220
		Grand Scénic (JZ_) (09-)	24.0111-0180.2	8624	GRAND SCÉNIC III (JZ0/1_)	01.02.2009	-	M24 center nut level 01	80
		Grand Scénic (JZ_) (09-)	24.0111-0180.2	8624	GRAND SCÉNIC III (JZ0/1_)	01.02.2009	-	M24 center nut level 02	280
		Grand Scénic (JZ_) (09-)	24.0111-0184.2	8624	GRAND SCÉNIC III (JZ0/1_)	01.02.2009	-	M24 center nut level 01	80
		Grand Scénic (JZ_) (09-)	24.0111-0184.2	8624	GRAND SCÉNIC III (JZ0/1_)	01.02.2009	-	M24 center nut level 02	280
		Grand Scénic III (JZ_) (09-)	24.0108-0118.2	8624	GRAND SCÉNIC III (JZ0/1_)	01.02.2009	-	M24 center nut level 01	80
		Grand Scénic III (JZ_) (09-)	24.0108-0118.2	8624	GRAND SCÉNIC III (JZ0/1_)	01.02.2009	-	M24 center nut level 02	280
		Kangoo Be Bop (KW0_) (09-10)	24.0111-0174.2	8392	KANGOO BE BOP (KW0/1_)	01.02.2009	-	Center nut	300
		Kangoo Express/Rapid (FW_) (08-)	24.0111-0174.2	7618	KANGOO Express (FW0/1_)	01.02.2008	-	Center nut	300
Kangoo Express/Rapid (FW_) (08-)		24.0111-0182.2	7618	KANGOO Express (FW0/1_)	01.02.2008	-	Center nut	300	
Kangoo II (KW_) (08-)		24.0111-0174.2	7617	KANGOO/GRAND KANGOO (KW0/1_)	01.02.2008	-	Center nut	300	
Kangoo II (KW_) (08-)		24.0111-0182.2	7617	KANGOO/GRAND KANGOO (KW0/1_)	01.02.2008	-	Center nut	300	
Laguna III Coupe (DT0/1) (07-15)		24.0111-0181.2	8327	LAGUNA Coupe (DT0/1)	01.09.2008	-	Center nut	280	
Laguna III Grandtour (KT0/1) (07-15)		24.0111-0173.2	7545	LAGUNA III Grandtour (KT0/1)	01.10.2007	-	Center nut	280	
Laguna III Sedan (BT0/1) (07-15)		24.0111-0173.2	7544	LAGUNA III (BT0/1)	01.10.2007	-	Center nut	280	
Latitude (L70_) (11-13)		24.0111-0173.2	8920	LATITUDE (L70_)	01.07.2010	-	Center nut level 01	80	
Latitude (L70_) (11-13)		24.0111-0173.2	8920	LATITUDE (L70_)	01.07.2010	-	Center nut level 02	280	
Mégane II Coupe/Convertible (EM_) (03-10)	24.0108-0114.2	2609	MÉGANE II Coupe-Convertible (EM0/1_)	01.09.2003	01.12.2009	M20 center nut for brake disc 240x8 mm	175		
Mégane II Coupe/Convertible (EM_) (03-10)	24.0110-0389.2	2609	MÉGANE II Coupe-Convertible (EM0/1_)	01.09.2003	01.12.2009	M20 center nut for brake disc 270x10 mm	220		

Manufacturer	Model	ATE article no.	Range ID	Range name	from	to	QualColText	Tightening torques wheel bearings (Nm)
RENAULT	Mégane II Coupe/Convertible (EM_) (03-10)	24.0110-0389.2	2609	MÉGANE II Coupe-Convertible (EM0/1_)	01.09.2003	01.12.2009	M24 center nut level 01	80
							M24 center nut level 02	280
	Mégane II Grandtour (KM_) (03-08)	24.0110-0389.2	2611	MÉGANE II Estate (KM0/1_)	01.08.2003	01.08.2012	M20 center nut for brake disc 270x10 mm	220
							M24 center nut level 01	80
	Mégane II Grandtour (KM_) (03-08)	24.0110-0389.2	2611	MÉGANE II Estate (KM0/1_)	01.08.2003	01.08.2012	M24 center nut level 02	280
							M24 center nut level 01	80
	Mégane II Sedan 3-/5-door (BM/CM_) (02-08)	24.0111-0183.2	2513	MÉGANE II (BM0/1_ CM0/1_)	01.11.2002	01.01.2011	M20 center nut for brake disc 240x8 mm	175
							M20 center nut for brake disc 270x10 mm	220
	Mégane II Sedan 3-/5-door (BM/CM_) (02-08)	24.0111-0183.2	2513	MÉGANE II (BM0/1_ CM0/1_)	01.11.2002	01.01.2011	M24 center nut level 01	80
							M24 center nut level 02	280
	Mégane II Sedan 3-/5-door (BM/CM_) (02-08)	24.0111-0183.2	2513	MÉGANE II (BM0/1_ CM0/1_)	01.11.2002	01.01.2011	M20 center nut for brake disc 240x8 mm	175
							M20 center nut for brake disc 270x10 mm	220
	Mégane II Sedan 4-door (LM_) (03-08)	24.0110-0389.2	2610	MÉGANE II Notchback (LM0/1_)	01.09.2003	01.09.2003	M24 center nut level 01	80
							M24 center nut level 02	280
	Mégane II Sedan 4-door (LM_) (03-08)	24.0110-0389.2	2610	MÉGANE II Notchback (LM0/1_)	01.09.2003	01.09.2003	M20 center nut for brake disc 240x8 mm	175
							M20 center nut for brake disc 270x10 mm	220
	Mégane II Sedan 4-door (LM_) (03-08)	24.0110-0389.2	2610	MÉGANE II Notchback (LM0/1_)	01.09.2003	01.09.2003	M24 center nut level 01	80
							M24 center nut level 02	280
	Mégane II Sedan B54/G 3-/5-door (BM/CM_) (02-08)	24.0110-0389.2	2513	MÉGANE II (BM0/1_ CM0/1_)	01.11.2002	01.01.2011	M20 center nut for brake disc 240x8 mm	175
							M20 center nut for brake disc 270x10 mm	220
	Mégane II Sedan B54/G 3-/5-door (BM/CM_) (02-08)	24.0110-0389.2	2513	MÉGANE II (BM0/1_ CM0/1_)	01.11.2002	01.01.2011	M24 center nut level 01	80
							M24 center nut level 02	280
	Mégane III CC (EZ0_) (10-)	24.0108-0116.2	8770	MÉGANE III CC (EZ0/1_)	01.06.2010	01.06.2010	M24 center nut level 01	80
							M24 center nut level 02	280
	Mégane III CC (EZ0_) (10-)	24.0108-0118.2	8770	MÉGANE III CC (EZ0/1_)	01.06.2010	01.06.2010	M24 center nut level 01	80
							M24 center nut level 02	280
Mégane III Coupe (DZ0_) (08-)	24.0108-0116.2	8362	MÉGANE III Coupe (DZ0/1_)	01.11.2008	01.11.2008	M20 center nut	220	
						M24 center nut level 01	80	
Mégane III Coupe (DZ0_) (08-)	24.0108-0116.2	8362	MÉGANE III Coupe (DZ0/1_)	01.11.2008	01.11.2008	M24 center nut level 02	280	
						M24 center nut level 01	80	
Mégane III Coupe (DZ0_) (08-)	24.0111-0186.2	8362	MÉGANE III Coupe (DZ0/1_)	01.11.2008	01.11.2008	M20 center nut	220	
						M24 center nut level 01	80	
Mégane III Coupe (DZ0_) (08-)	24.0111-0186.2	8362	MÉGANE III Coupe (DZ0/1_)	01.11.2008	01.11.2008	M24 center nut level 02	280	
						M24 center nut level 01	80	
Mégane III Grandtour (KZ_) (08-)	24.0108-0116.2	8538	MÉGANE III Grandtour (KZ0/1)	01.11.2008	01.11.2008	M24 center nut level 01	80	
						M24 center nut level 02	280	
Mégane III Grandtour (KZ_) (08-)	24.0108-0118.2	8538	MÉGANE III Grandtour (KZ0/1)	01.11.2008	01.11.2008	M24 center nut level 01	80	
						M24 center nut level 02	280	
Mégane III Hatchback (BZ0_) (08-)	24.0108-0116.2	8361	MÉGANE III Hatchback (BZ0_)	01.11.2008	01.11.2008	M20 center nut	220	
						M24 center nut level 01	80	
Scénic III (JZ_) (09-)	24.0108-0118.2	8528	SCÉNIC III (JZ0/1_)	01.02.2009	01.02.2009	M24 center nut level 01	80	
						M24 center nut level 02	280	
Scénic III (JZ_) (09-)	24.0111-0180.2	8528	SCÉNIC III (JZ0/1_)	01.02.2009	01.02.2009	M24 center nut level 01	80	
						M24 center nut level 02	280	
Trafic III (14-)	24.0112-0217.2	12118	TRAFIC III Bus (JG_)	01.05.2014	01.05.2014	Center nut	280	

Important information

During installation, make sure that the wheel bearing is not tilted.

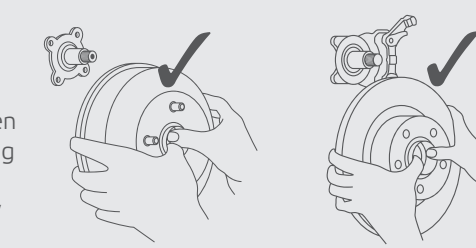

Caution: if a wheel bearing has been pulled apart or the bearing inner ring pressed out during assembly, the wheel bearing is defective and may no longer be installed.

Caution: during the tightening process the brake disc/brake drum must be turned! This prevents damage to the bearing shells.

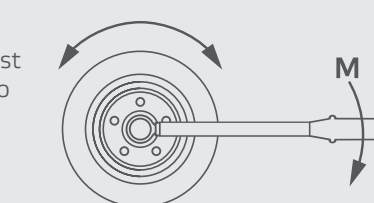

The hub nut must be put on and tightened by hand. Under no circumstances use an impact wrench!

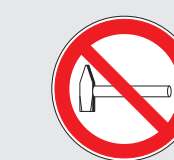

Do not exert any mechanical force during installation: do not use hammers or other similar tools!



Protect the encoder wheel from strong magnetic fields! Damage could otherwise occur, making the wheel bearing unusable.



Brakethrough Technology